

Retatrutide Pen

Instructions on how to use Retatrutide 16 mg solution for injection in pre-filled pen

Please read these instructions carefully before using your pre-filled pen. Talk to your doctor, nurse or pharmacist about how to inject correctly. Start by checking your pen to **make sure that it contains Retatrutide 16mg**, then look at the illustrations below to get to know the different parts of your pen and needle. **If you are blind or have poor eyesight and cannot read the dose counter on the pen, do not use this pen without help.** Get help from a person with good eyesight who knows how to use the pre-filled pen.

Your pen is a pre-filled dial-a-dose pen. It contains **16 mg** of **Retatrutide**. There are 3 injection dosages for you to choose from: **1mg, 2mg, 4mg**

Your pen is designed to be used with 30G, 31G, and 32G disposable needles up to a length of 6 mm. Needles are included in the pack.

Storage: 2-8 degrees Celsius, 35.6-46.4 degrees Fahrenheit

Pre-filled pen and Needle (example)

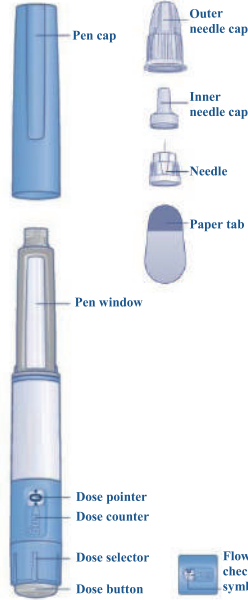

Important information

Pay special attention to these notes, as they are important for safe use of the pen.

1. Prepare your pen with a new needle

- Check the name and coloured label of your pen, to make sure that it contains **Retatrutide 16mg**. This is especially important if you take more than one type of injectable medicine. Using the wrong medicine could be harmful to your health.
- Pull off the pen cap.**

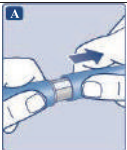

- Check that the solution in your pen is clear and colourless. Look through the pen window. If the solution looks cloudy or coloured, do not use the pen.



- Take a new needle. Check the paper tab and the outer needle cap for damages that could affect sterility. If any damage is seen use a new needle.
- Tear off the paper tab.**



Make sure to attach the needle correctly.

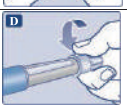

- Push the needle straight onto the pen.
- Turn until it is on **tight**.

The needle is covered by two caps. You must remove both caps. If you forget to remove both caps, you will **not** inject any solution.

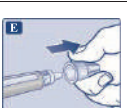

- Pull off the outer needle cap and keep it for later.** You will need it after the injection, to safely remove the needle from the pen.

- Pull off the inner needle cap and throw it away.** If you try to put it back on, you may accidentally stick yourself with the needle.

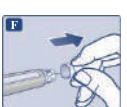

A drop of solution may appear at the needle tip. This is normal, but you must still check the flow, if you use a new pen for the first time. See step 2 'Check the flow with each new pen'. **Do not attach a new needle to your pen until you are ready to take your injection.**

Always use a new needle for each injection.

This may prevent blocked needles, contamination, infection and inaccurate dosing.

Never use a bent or damaged needle.

2. Check the flow with each new pen

- If your pen is already in use, go to step 3 'Select your dose'. Only check the flow before your **first injection with each new pen**.

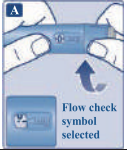

- Turn the dose selector to the **flow check symbol** (**) right past '0'. Make sure the flow check symbol lines up with the pointer.

- Hold the pen with the needle pointing up. **Press and hold in the dose button** until the dose counter returns to '0'. The '0' must line up with the dose pointer. A drop of solution should appear at the needle tip.

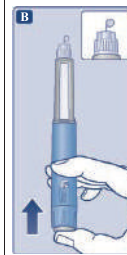

A small drop may remain at the needle tip, but it will not be injected.

If no drop appears, repeat step 2 'Check the flow with each new pen' up to 6 times. If there is still no drop, change the needle and repeat step 2 'Check the flow with each new pen' once more. Dispose of the pen and use a new one if a drop of solution still does not appear.

Always make sure that a drop appears at the needle tip before you use a new pen for the first time. This makes sure that the solution flows. If no drop appears, you will **not** inject any medicine even though the dose counter may move. **This may indicate a blocked or damaged needle.** If you do not check the flow before your first injection with each new pen, you may not get the prescribed dose and the intended effect of pen.

3. Select your dose

- Turn the dose selector to select 1 mg (2mg, 4mg).** Keep turning until the dose counter stops and shows 4 mg.

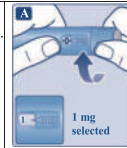

Always use the dose counter and the dose pointer to see that 1 mg has been selected before injecting this medicine.

Do not count the pen clicks.





1 mg must line up precisely with the dose pointer to ensure that you get a correct dose.



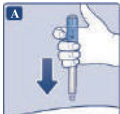
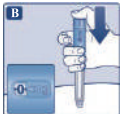

How much solution is left

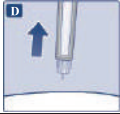
- To see how much solution is left, use the dose counter: Turn the dose selector until the **dose counter stops**. If it shows 1, **at least 1 mg** is left in your pen. If the **dose counter stops before 1 mg**, there is not enough solution left for a full dose of 1mg.

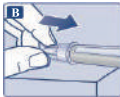
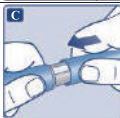

If there is not enough solution left in your pen for a full dose, do not use it. Use a new pen.

4. Inject your dose	
<ul style="list-style-type: none"> Insert the needle into your skin as your doctor or nurse has shown you. Make sure you can see the dose counter. Do not cover it with your fingers. This could interrupt the injection. 	
<ul style="list-style-type: none"> Press and hold down the dose button. Watch as the dose counter returns to '0'. The '0' must line up with the dose pointer. You may then hear or feel a click. 	
<ul style="list-style-type: none"> Continue pressing the dose button while keeping the needle in your skin. 	
<ul style="list-style-type: none"> Count slowly to 6, while keeping the dose button pressed. If the needle is removed earlier, you may see a stream of solution coming from the needle tip. If so, the full dose will not be delivered. 	
<ul style="list-style-type: none"> Remove the needle from your skin. You can then release the dose button. If blood appears at the injection site, press lightly. 	
<p>You may see a drop of solution at the needle tip after injecting. This is normal and does not affect your dose.</p> <p> Always watch the dose counter to know how many mg you inject. Hold the dose button down until the dose counter returns to '0'.</p> <p>How to identify a blocked or damaged needle</p> <ul style="list-style-type: none"> If '0' does not appear in the dose counter after continuously pressing the dose button, you may have used a blocked or damaged needle. In this case, you have not received any medicine – even though the dose counter has moved from the original dose that you have set. <p>How to handle a blocked needle</p> <p>Change the needle as described in step 5 'After your injection' and repeat all steps starting with step 1 'Prepare your pen with a new needle'. Make sure you select the full dose you need.</p> <p>Never touch the dose counter when you inject. This can interrupt the injection.</p>	
5. After your injection	
<ul style="list-style-type: none"> Always dispose of the needle after each injection to ensure convenient injections and prevent blocked needles. If the needle is blocked, you will not inject any medicine. Lead the needle tip into the outer needle cap on a flat surface without touching the needle or the outer needle cap. 	

<ul style="list-style-type: none"> Once the needle is covered, carefully push the outer needle cap completely on. Unscrew the needle and dispose of it carefully as instructed by your doctor, nurse, pharmacist or local authorities. 	
<ul style="list-style-type: none"> Put the pen cap on your pen after each use to protect the solution from light. 	
<p>When the pen is empty, throw it away without a needle on as instructed by your doctor, nurse, pharmacist or local authorities.</p> <p> Never try to put the inner needle cap back on the needle. You may stick yourself with the needle.</p> <p> Always remove the needle from your pen immediately after each injection. This may prevent blocked needles, contamination, infection, leakage of solution and inaccurate dosing.</p> <p> Further important information</p> <ul style="list-style-type: none"> Always keep your pen and needles out of the sight and reach of others, especially children. Never share your pen or your needles with other people. Caregivers must be very careful when handling used needles to prevent needle injury and cross-infection. 	
Caring for your pen	
<p>Treat your pen with care. Rough handling or misuse may cause inaccurate dosing. If this happens you might not get the intended effect of this medicine.</p> <ul style="list-style-type: none"> Do not leave the pen in a car or another place where it can get too hot or too cold. Do not inject MD which has been frozen. If you do that, you might not get the intended effect of this medicine. Do not inject MD which has been exposed to direct sunlight. If you do that, you might not get the intended effect of this medicine. Do not expose your pen to dust, dirt or liquid. Do not wash, soak or lubricate your pen. It may be cleaned with a mild detergent on a moistened cloth. Do not drop your pen or knock it against hard surfaces. If you drop it or suspect a problem, attach a new needle and check the flow before you inject. Do not try to refill your pen. Once empty, it must be disposed of. Do not try to repair your pen or pull it apart. 	